

Cardiff Beach Living Shoreline Project

Project Overview

This project constructs new dunes, pedestrian pathway, curb ramps, and beach access points from the Chart House Restaurant to South Cardiff State Beach. The project is a collaborative effort from California Coastal Commission, State Coastal Conservancy, Federal Fish and Wildlife, State Parks and San Elijo Lagoon Conservancy.

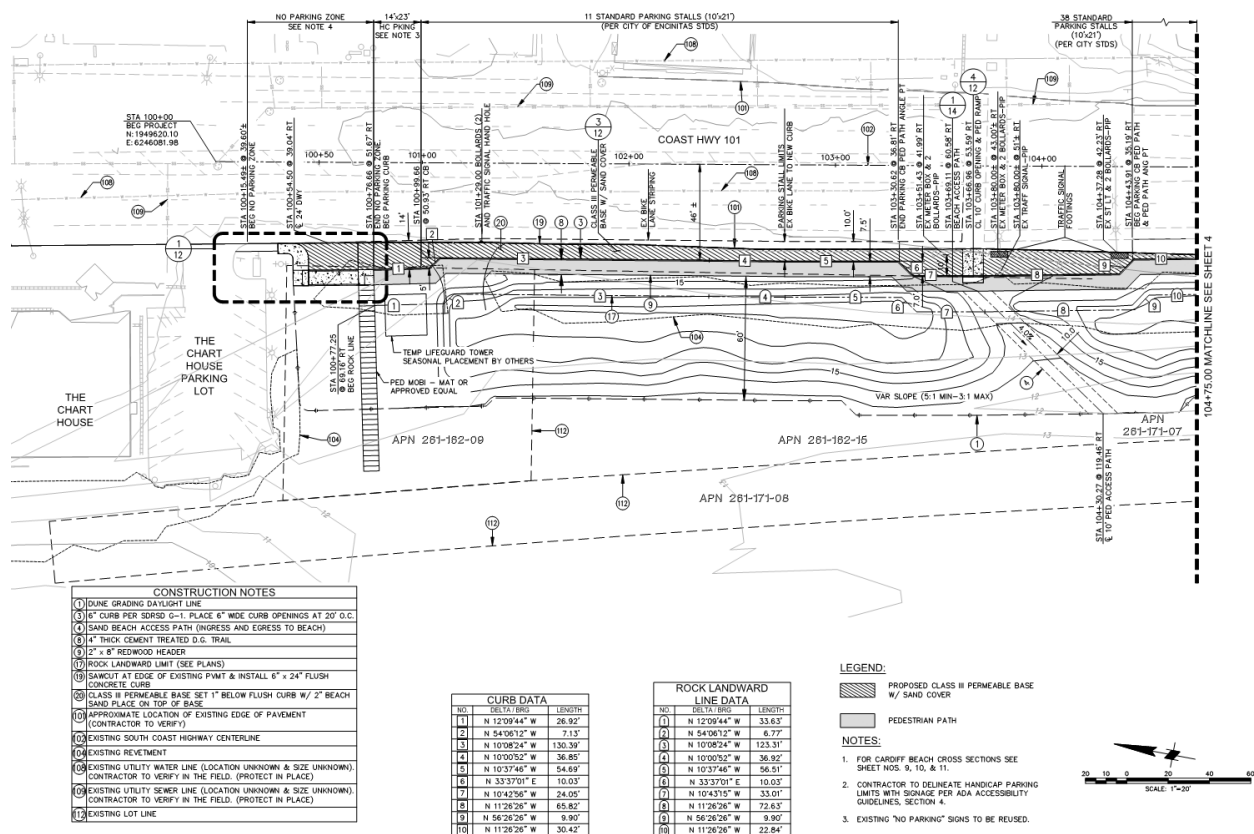

Benefits

Construction of the dunes will protect Highway 101 from storm damage while providing a dedicated pathway over the project length connecting restaurant row to Solana Beach. Project will provide access to the beach through the newly constructed dunes with post and rope fence and informational signs.

Cost

The project's construction budget is approximately \$2,200,000

Schedule

- Start construction in early October 2018
- Complete construction in August 2019

**All dates are approximate and subject to change. Last Updated January 29, 2019*

Contact Us

For questions or concerns about the project, please contact the Project Manager by phone or email:

Peter Milligan, Engineer II
Pmilligan@encinitasca.gov
760-633-2775